



Assembly and operation manual

Barrier **BV-5-868**

English

Montage-und Betriebsanleitung

Schranke **BV-5-868**

Deutsch

Manuel d'installation et d'utilisation

Barrière **BV-5-868**

Français

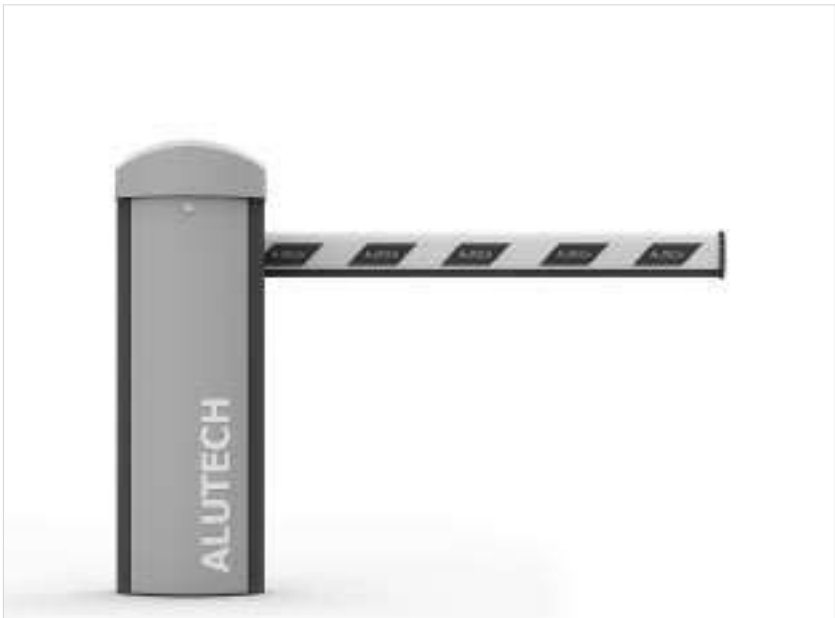

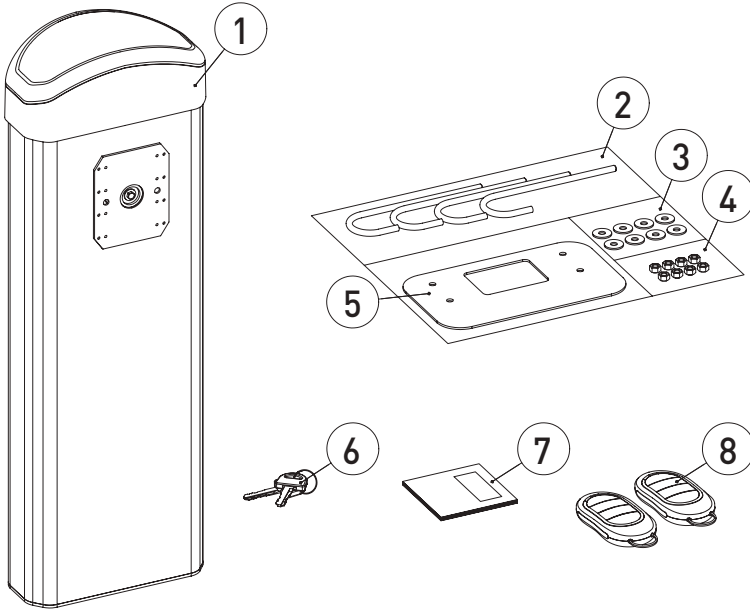
1

EN
DE
FR

1	Barrier cabinet	Schrankengehäuse	Socle de la barrière
2	Fundamental hook M12 (4 pcs.)	Fundamenthaken M12 (4 Stk.)	Crochet M12 de fondation (4 pcs.)
3	Flat washer 12 (8 pcs.)	Unterlegscheibe 12 (8 Stk.)	Rondelle plate 12 (8 pcs.)
4	Nut M12 (8 pcs.)	Mutter M12 (8 Stk.)	Écrou M12 (8 pcs.)
5	Mounting base (1 p.)	Montage-Grundplatte (1 Stk.)	Base de montage (1 pièce)
6	Key (2 pcs.)	Schlüssel für Türschloss am Schrankengehäuse (2 Stk.)	Clé de verrouillage de porte de la barrière (2 pièces)
7	Assembly and operation manual	Montage- und Bedienungsanleitung	Notice d'installation et d'utilisation
8	Remote control AT-4N-868 (2 pcs.)	Fernbedienung AT-4N-868 (2 Stk.)	Télécommande radio AT-4N-868 (2 pièces)



ATTENTION! All dimensions in this manual are indicated in millimeters.

ACHTUNG! Die Abmessungen in den Anleitungsabbildungen sind in Millimeter angegeben.

ATTENTION ! Les dimensions dans les figures du Manuel sont indiquées en millimètres.

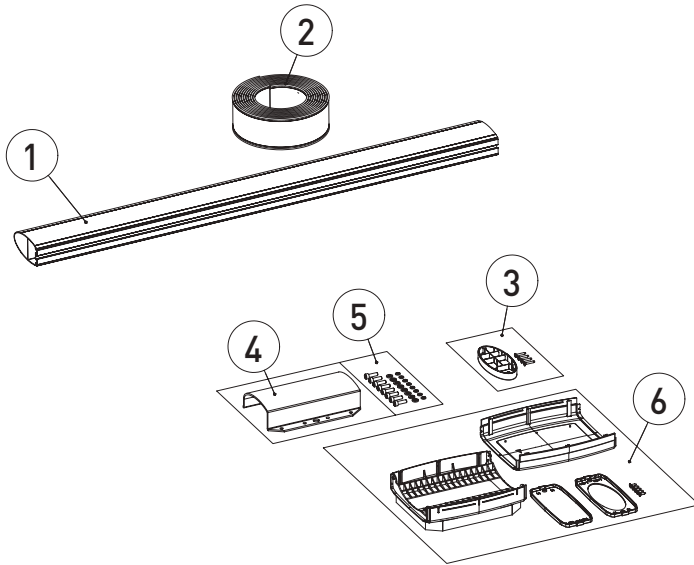
2

EN

- 1** Boom profile RBN8
- 2** Damping device
- 3** Cap (1 p.) complete with screws 3.5×22 (3 pcs.)
- 4** Boom mounting bracket (1 p.)
- 5** Fastening kit for boom mounting:
 • screw M6×20 (8 pcs.),
 • flat washer 6 (8 pcs.),
 • spring washer 6 (8 pcs.)
- 6** Boom mounting cover kit (1 p.)

DE

- Schrankenbaumprofil RBN8
- Dämpfer
- Kappe (1 Stk.) komplett mit Schraube 3,5×22 (3 Stk.)
- Schrankenbaum-Halterung (1 Stk.)
- Montageset für Schrankenbaum-Halterung:
 • Schraube M6×20 (8 Stk.),
 • Unterlegscheibe 6 (8 Stk.),
 • Federring 6 (8 Stk.)
- Schrankenbaum-Montageabdeckung (1 Stk.)

FR

- Profilé de la lisse RBN8
- Équilibreur dynamique
- Bouchon obturateur (1 pièce) livré avec la vis 3,5×22 (3 pièces)
- Support de fixation de la lisse (1 pièce)
- Jeu de fixations pour le montage de la lisse :
 • vis M6×20 (8 pcs.) ;
 • rondelle plate 6 (8 pcs.) ;
 • écrou de ressort 6 (8 pcs.)
- Kit du boîtier de montage de la lisse (1 pièce)

3

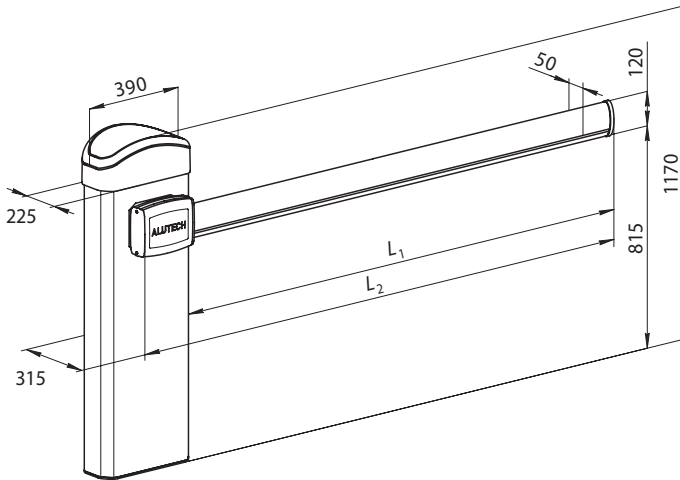

EN

L_1 Effective boom length

L_2 Boom profile length

DE

Schrankenbaumnutzlänge

Schrankenbaumlänge

FR

Longueur effective de la lisse

Longueur du profilé de la lisse

4

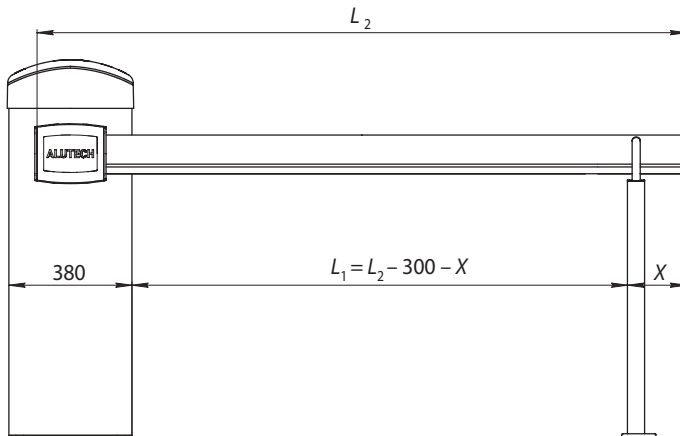

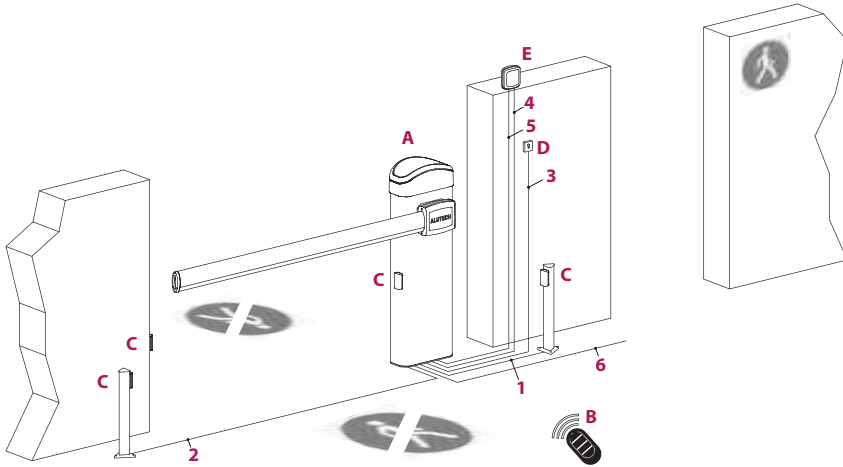
5

EN

A	Barrier
B	Remote control
C	Photocells
D	Key switch
E	Lamp (antenna)
1	RX photocells receiver cable
2	TX photocells transmitter cable
3	Key switch cable
4	Lamp cable
5	Antenna cable
6	Mains cable

DE

A	Schranke
B	Funkfernbedienung
C	Lichtschranke
D	Schlüsselschalter
E	Lampe (Antenne)
1	Empfängerkabel RX für Lichtschranke
2	Senderkabel TX für Lichtschranke
3	Schlüsselschalter-Kabel
4	Lampenkabel
5	Antennenkabel
6	Stromversorgungskabel

FR

A	Barrière levante
B	Télécommande radio
C	Photocellules
D	Interrupcteur à clé
E	Lampe (antenne)
1	Câble du récepteur à photocellules RX
2	Câble de l'émetteur à photocellules TX
3	Câble de l'interrupteur à clé
4	Câble de lampe
5	Câble de l'antenne
6	Câble réseau

6

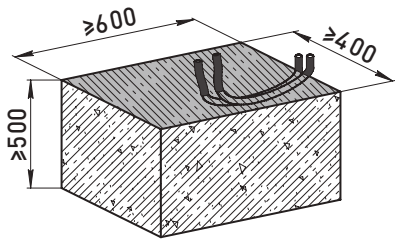

7

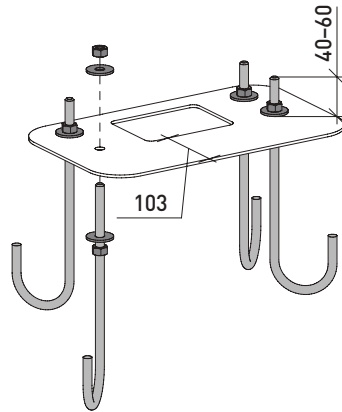

8

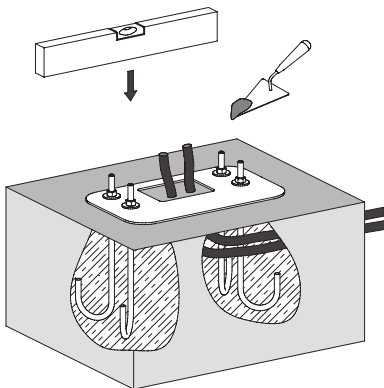

9

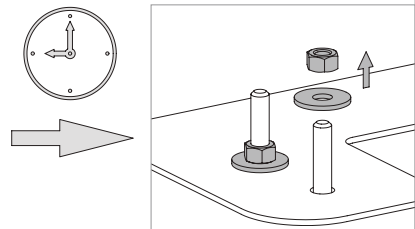
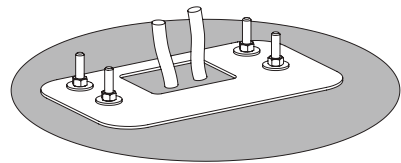

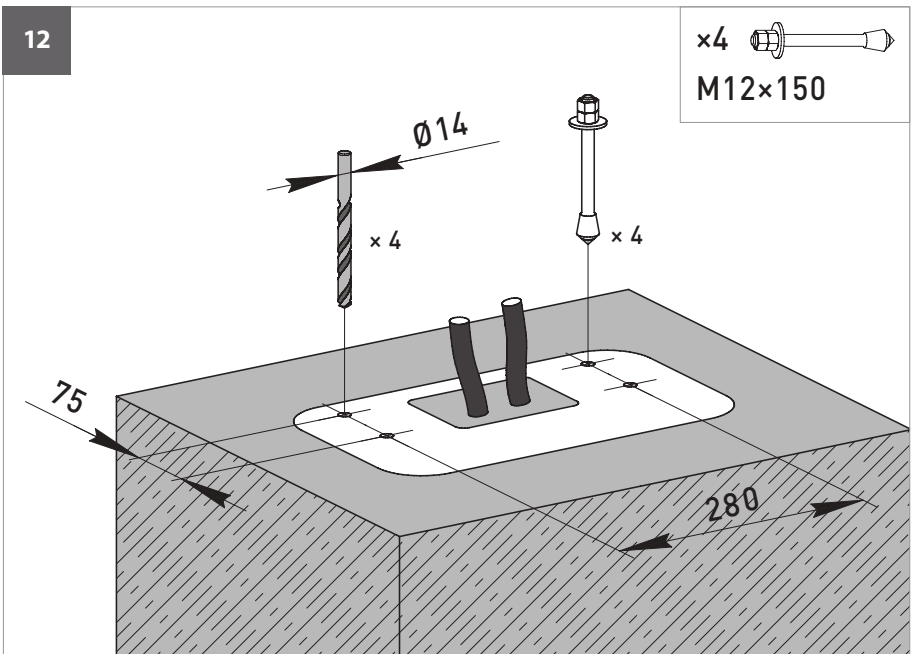
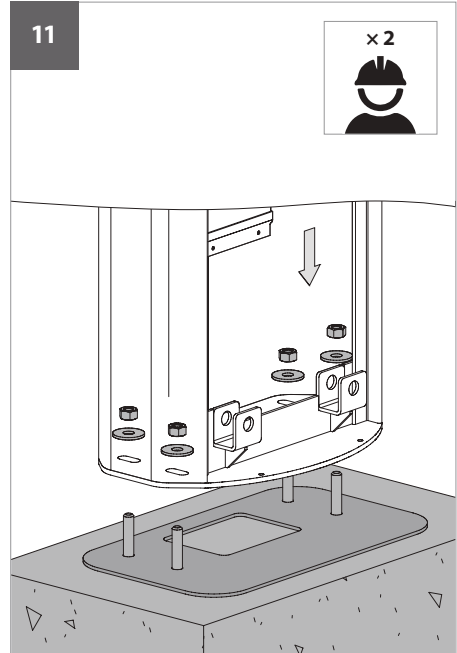
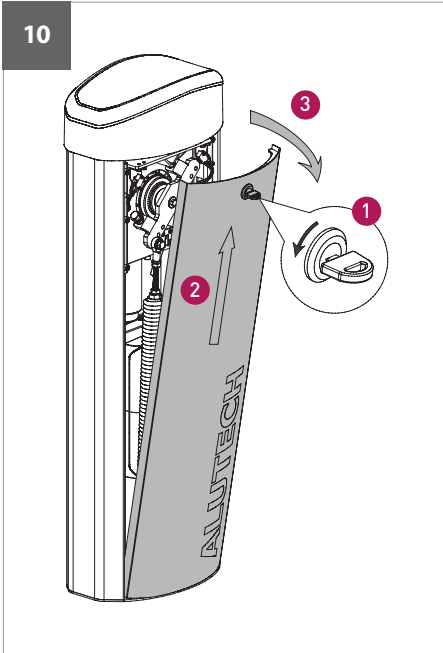

13

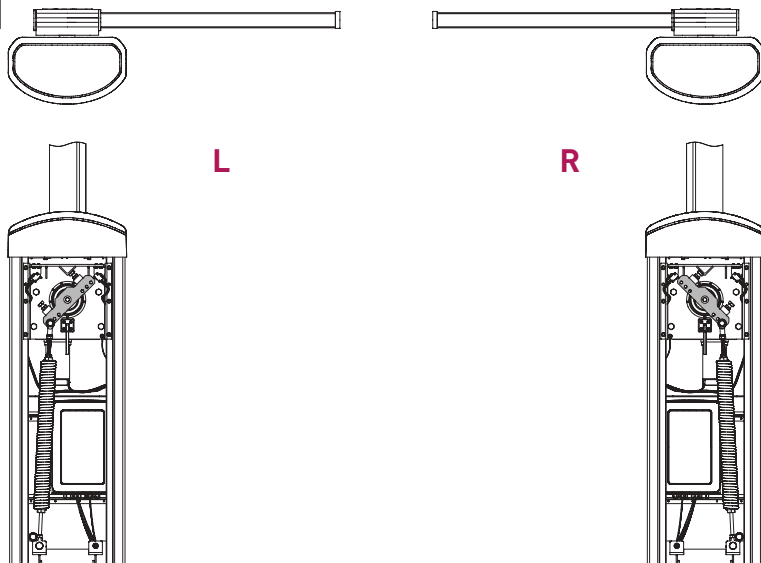

14

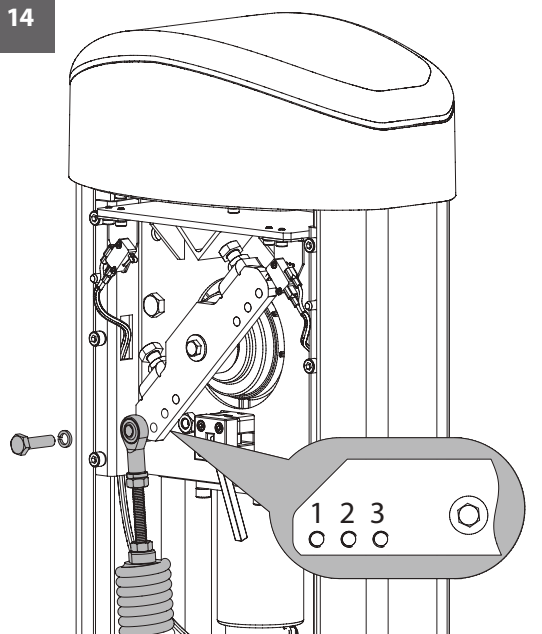

15

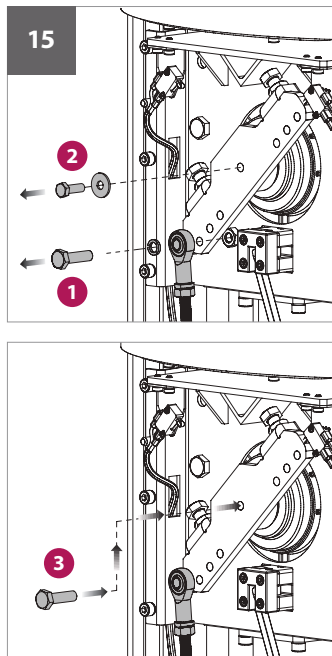

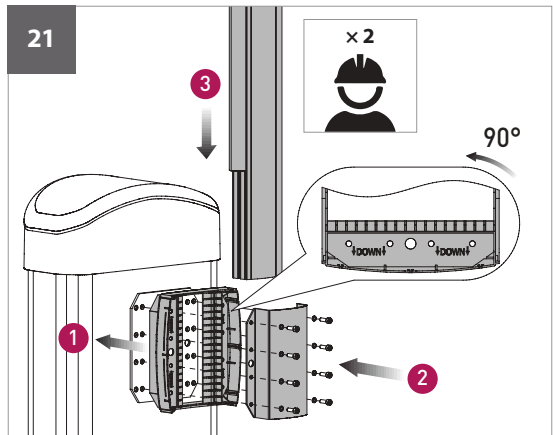
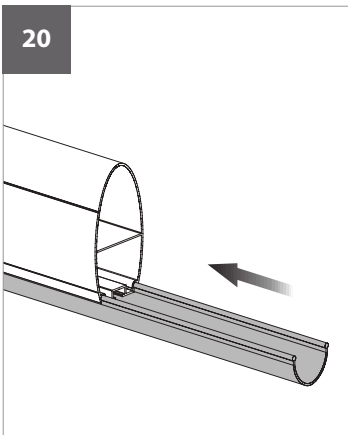
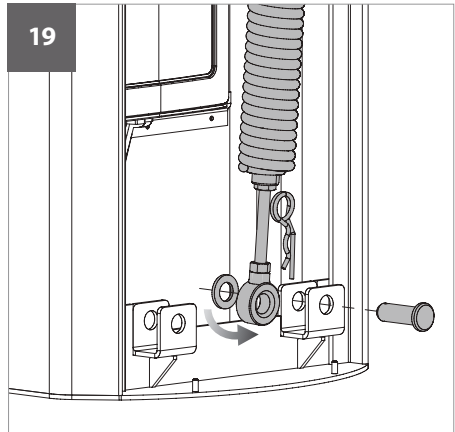
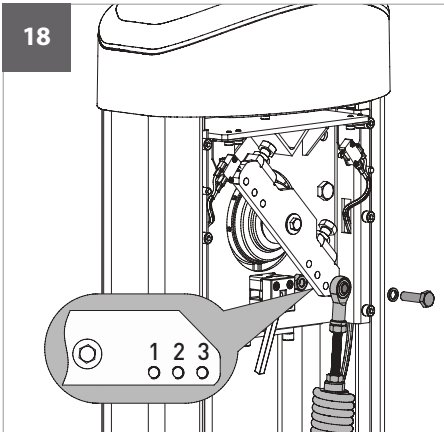
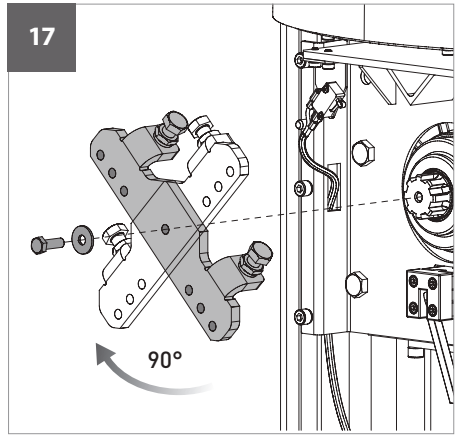
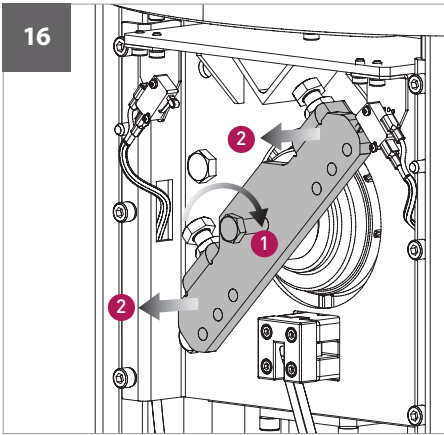

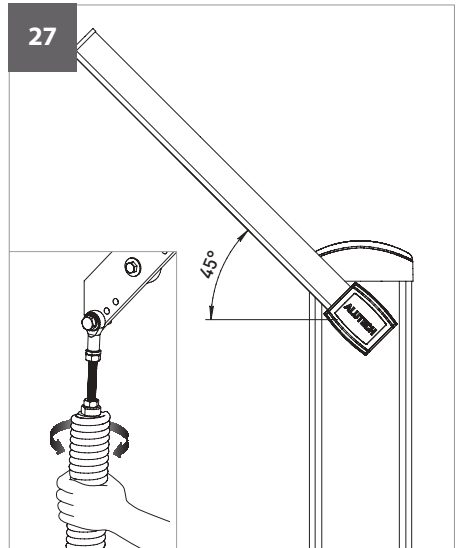
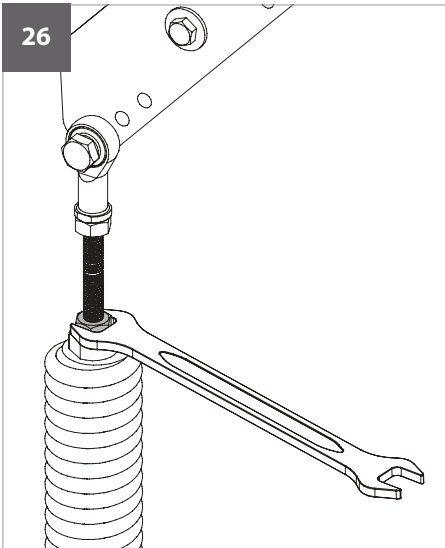
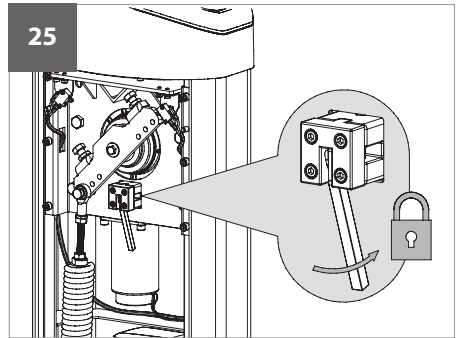
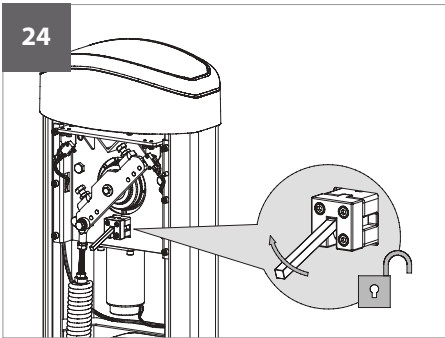
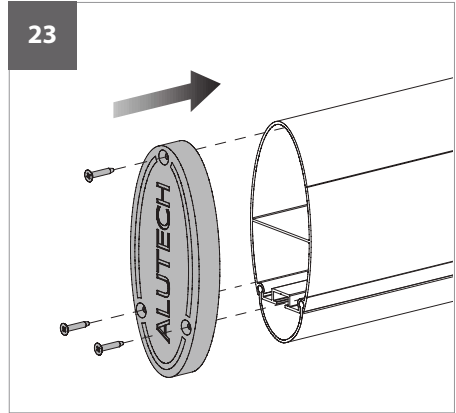
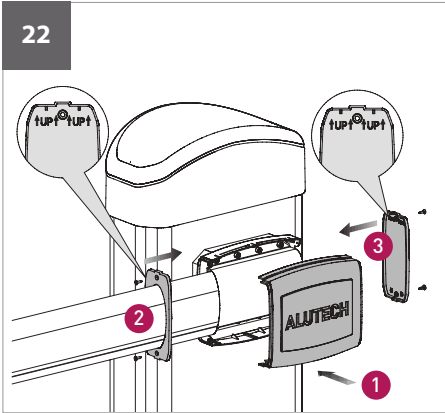

28

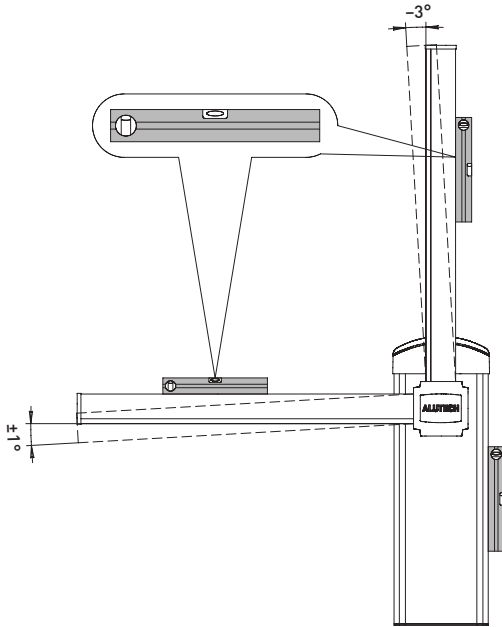

29

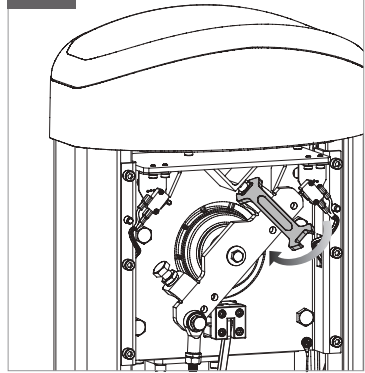

30

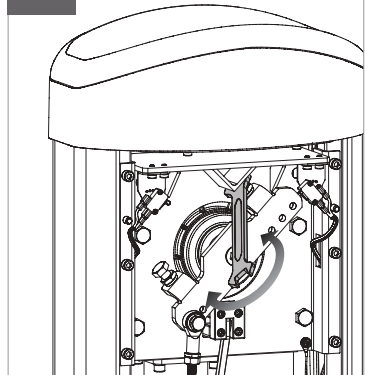

31

OFF

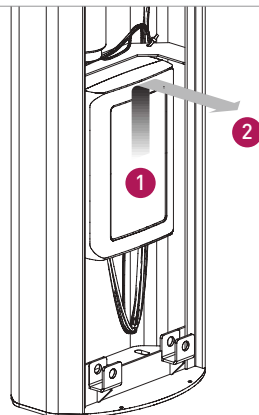
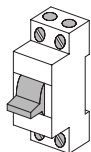

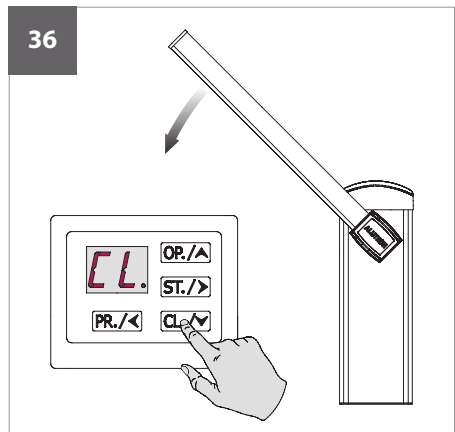
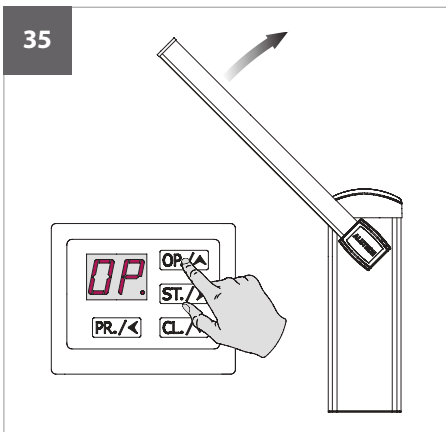
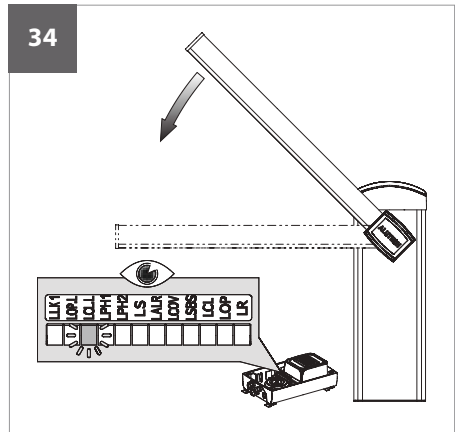
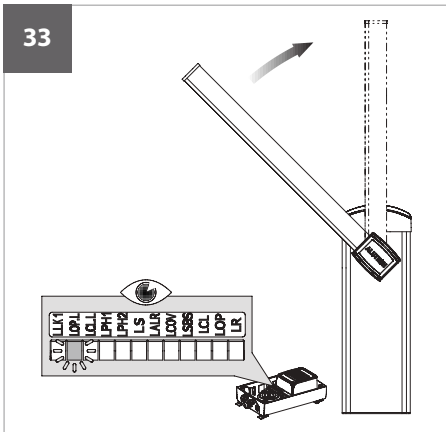
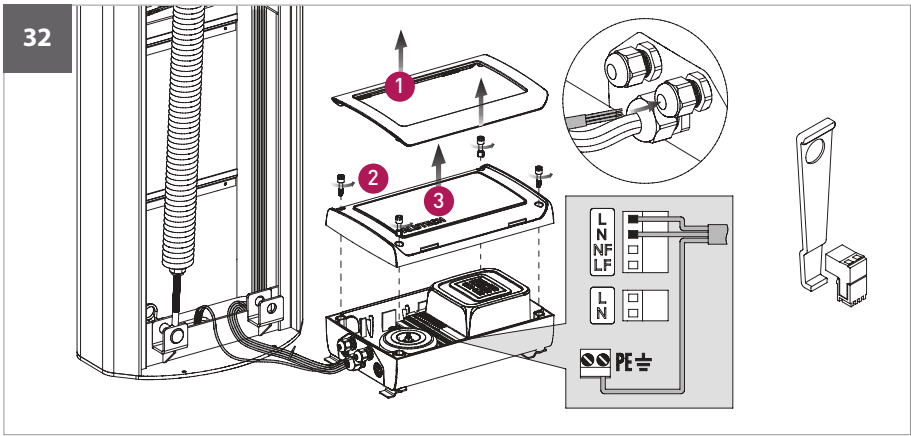

37

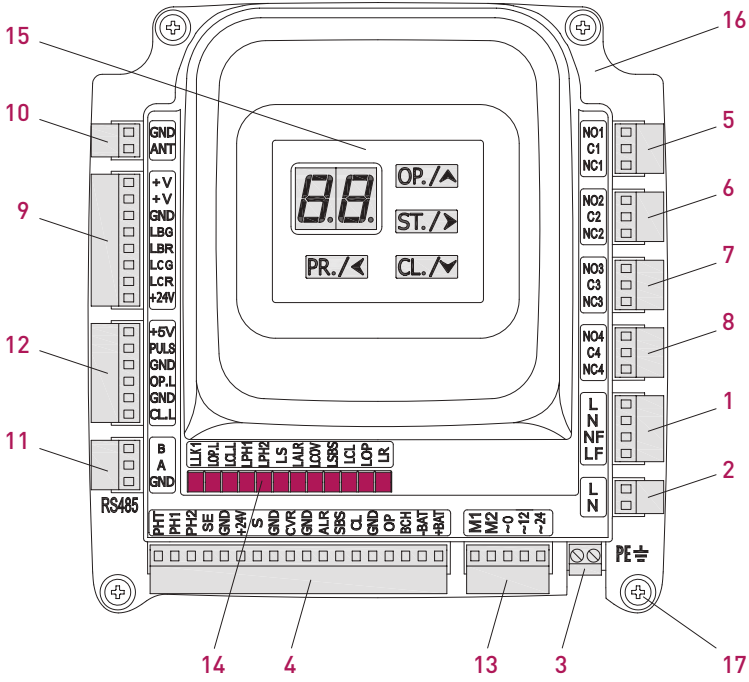

38

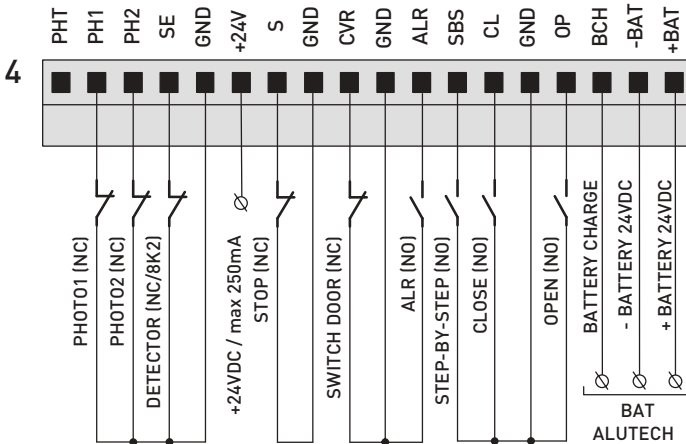

39

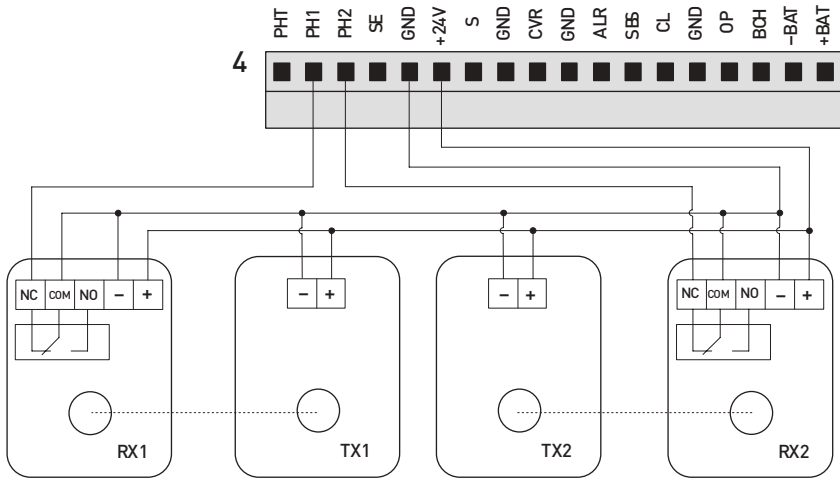

40A

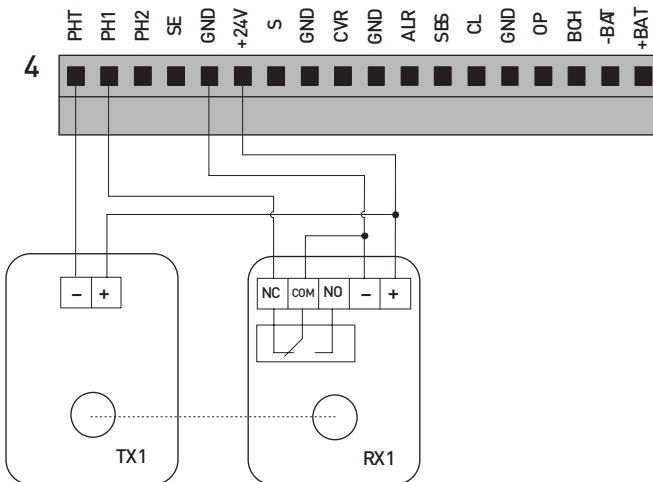

40B

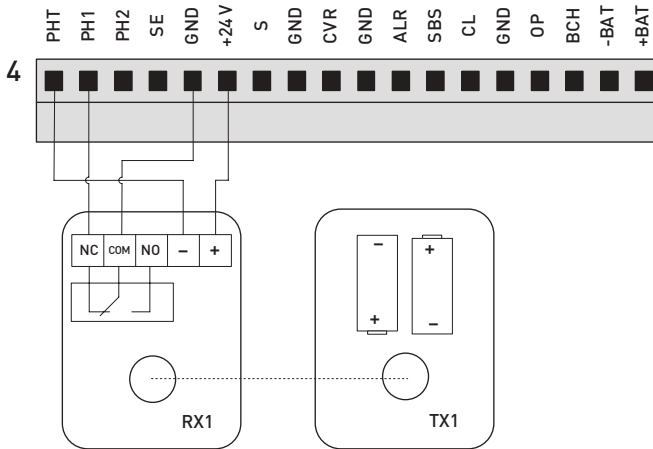

41

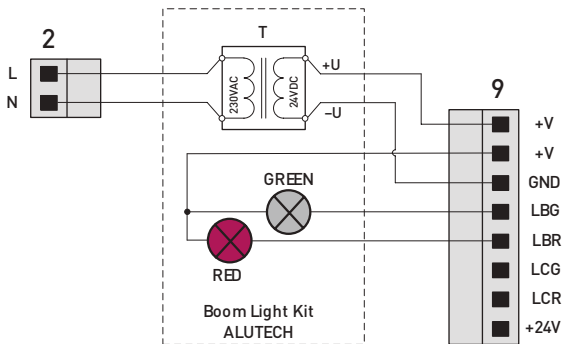

EN

DE

FR

	EN	DE	FR
T	Power supply	Stromversorgung	Source d'alimentation
GREEN	Green boom light	Grüne Schrankenbaum-Hintergrundbeleuchtung	Voyant vert de la bande de rétroéclairage de la lisse
RED	Red boom light	Rote Schrankenbaum-Hintergrundbeleuchtung	Voyant rouge de la bande de rétroéclairage de la lisse

42

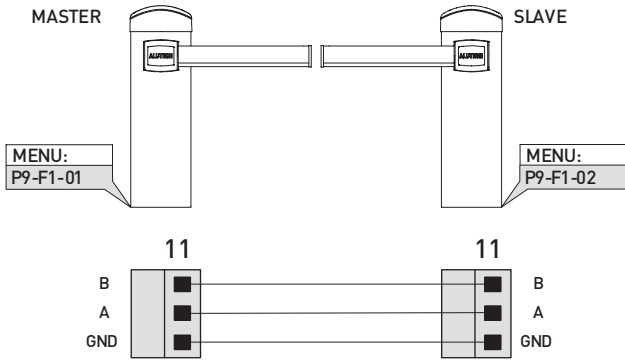

43

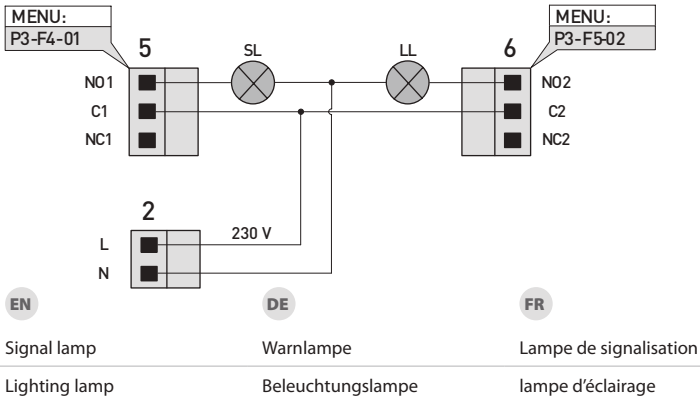

44

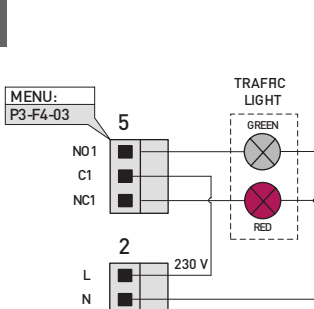

45

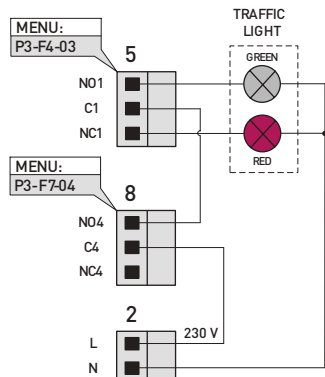

46

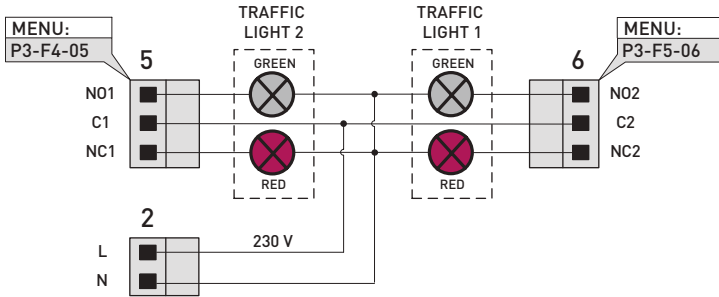

47

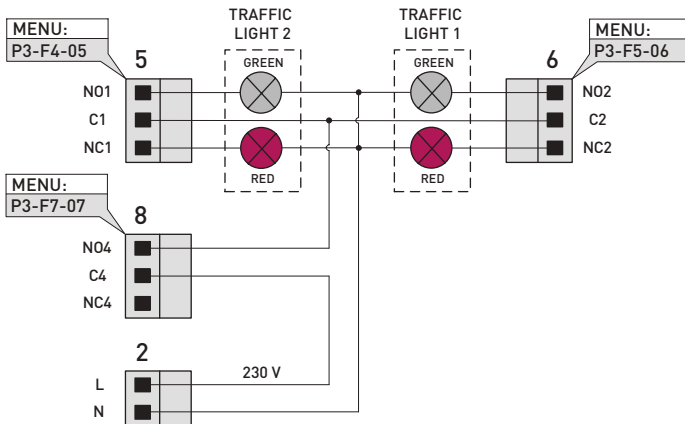

EN

DE

FR

TRAFFIC LIGHT Traffic light

Ampel

Feu de signalisation

GREEN Green traffic light

Grünes Ampellicht

Voyant de signalisation vert

RED Red traffic light

Rotes Ampellicht

Voyant de signalisation rouge

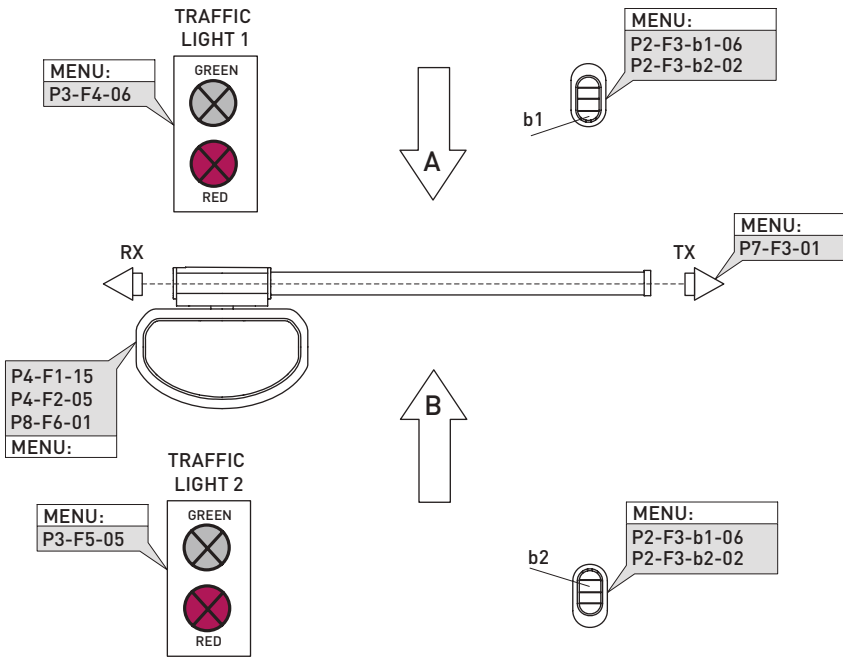

	EN	DE	FR
A	ENTRY direction	Richtung EINFAHRT	Sens ENTRÉE
B	EXIT direction	Richtung AUSFAHRT	Sens SORTIE
TRAFFIC LIGHT 1	ENTRY traffic light	Ampel EINFAHRT	Signalisation ENTRÉE
TRAFFIC LIGHT 2	EXIT traffic light	Ampel AUSFAHRT	Signalisation SORTIE
TX, RX	Photocells	Lichtschranken	Photocellules
b1, b2	Remote control buttons	Fernbedienungstasten	Boutons de la télécommande radio

49

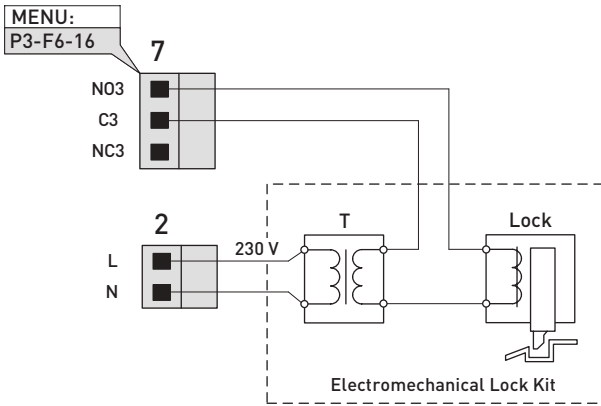

EN

DE

FR

T Power supply

Stromversorgung

Source d'alimentation

Lock Electric lock

Elektrisches Schloss

Serrure électrique

50

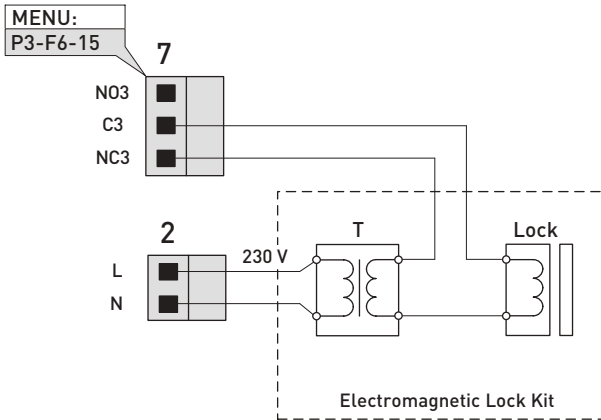

EN

DE

FR

T Power supply

Stromversorgung

Source d'alimentation

Lock Electric lock

Elektrisches Schloss

Serrure électrique

51

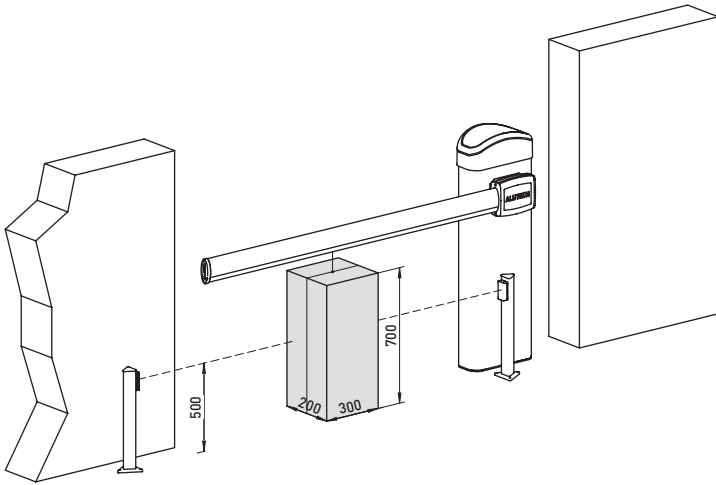

52

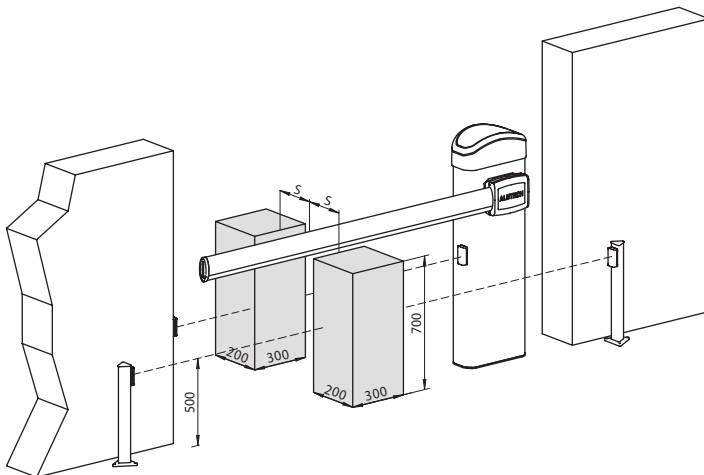

EN

S

To the boom profile lateral surface

DE

Bis zur Schrankenbaum-Seitenfläche

FR

Écart avec la surface latérale du profilé de la lisse

53

MENU:
P7-F4-03
P7-F4-04

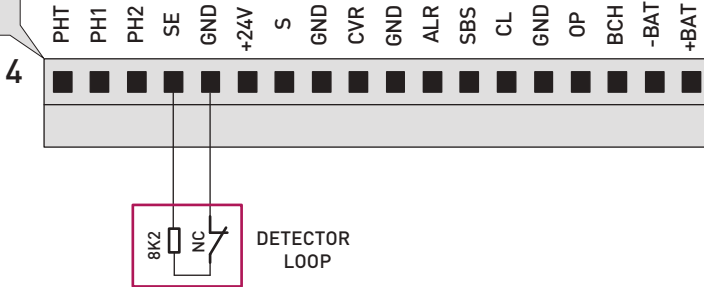



Czech Republic, 348 02
Bor u Tachova, CTPark Bor
Nova Hospoda 19, D5-EXIT 128
Phone/fax: + 420 374 6340 01
e-mail: info@cz.alutech-group.com

Tschechische Republik, 348 02
Bor u Tachova, CTPark Bor
Nova Hospoda 19, D5-EXIT 128
Telefon/Fax: + 420 374 6340 01
e-mail: info@cz.alutech-group.com

République Tchèque, 348 02
Bor u Tachova, CTPark Bor
Nova Hospoda 19, D5-EXIT 128
Tél./Fax : + 420 374 6340 01
e-mail : info@cz.alutech-group.com